

# Tompkins County Recycling and Solid Waste Center



## Disposal Options

T	D	S	E	H
<b>Tip Floor</b> <ul style="list-style-type: none"> <li>Weighted Vehicles</li> </ul>	<b>Drop-off Area</b> <ul style="list-style-type: none"> <li>Single Stream Recycling</li> <li>Food Scraps</li> <li>Textiles</li> </ul>	<b>Scrap Metal</b> <ul style="list-style-type: none"> <li>Ferrous and Non-ferrous</li> </ul>	<b>Electronics Plus</b> <ul style="list-style-type: none"> <li>Batteries (lead acid &amp; rechargeable)</li> <li>Electronics</li> <li>Fluorescent Bulbs*</li> <li>Feenix® Units*</li> <li>Propane Tanks</li> <li>Food Scraps</li> <li>Plastic Bags &amp; Film</li> <li>Rigid Plastics</li> <li>Tires*</li> <li>Yard Waste*</li> </ul>	<b>Household Hazardous Waste (HHW)</b> <ul style="list-style-type: none"> <li>Accepted on certain days of the year</li> <li>Visit <a href="http://www.recycle-tompkins.org">www.recycle-tompkins.org</a> for event dates.</li> </ul>

\*Fees Apply - All Users. \*\*Business or Commercial Users.

## Tompkins County Recycling and Materials Management

122 Commercial Ave.  
Ithaca, NY 14850  
[www.recycle-tompkins.org](http://www.recycle-tompkins.org)  
(607) 273-6632

# Map Key

- W** Weigh Station
- A** Attendant
- T** Tip Floor
- D** Drop-off Area
- F** Food Scraps
- S** Scrap Metal
- Y** Yard Waste
- E** Electronics Plus
- H** Household Hazardous Waste

## Before using the RSWC:

Only Tompkins County residents, businesses, and licensed haulers may drop off items that are accepted for a fee, including garbage, at the RSWC. Before visiting the facility, be sure to have:

- A valid Tompkins County Solid Waste Permit or Hauler's License
- Payment for items accepted for a fee via Punch Card, Coupon, check, or accepted credit card.

See *Permits & Fees* brochure or visit [www.recycletompkins.org](http://www.recycletompkins.org).

## RSWC Instructions:

- A. Users with disposal Punch Cards & Coupons go directly to the Drop-off area. **D**
- B. Garbage (weighed vehicles) **OR** items accepted for a fee.
  1. Stop at the Weigh Station. **W**
  2. User will be directed to the accepted item location for disposal options.
  3. After disposal, users weighed in must return to the Weigh Station **W** for payment.
- C. Items Accepted at **No Charge**:
  1. Go directly to the appropriate location.

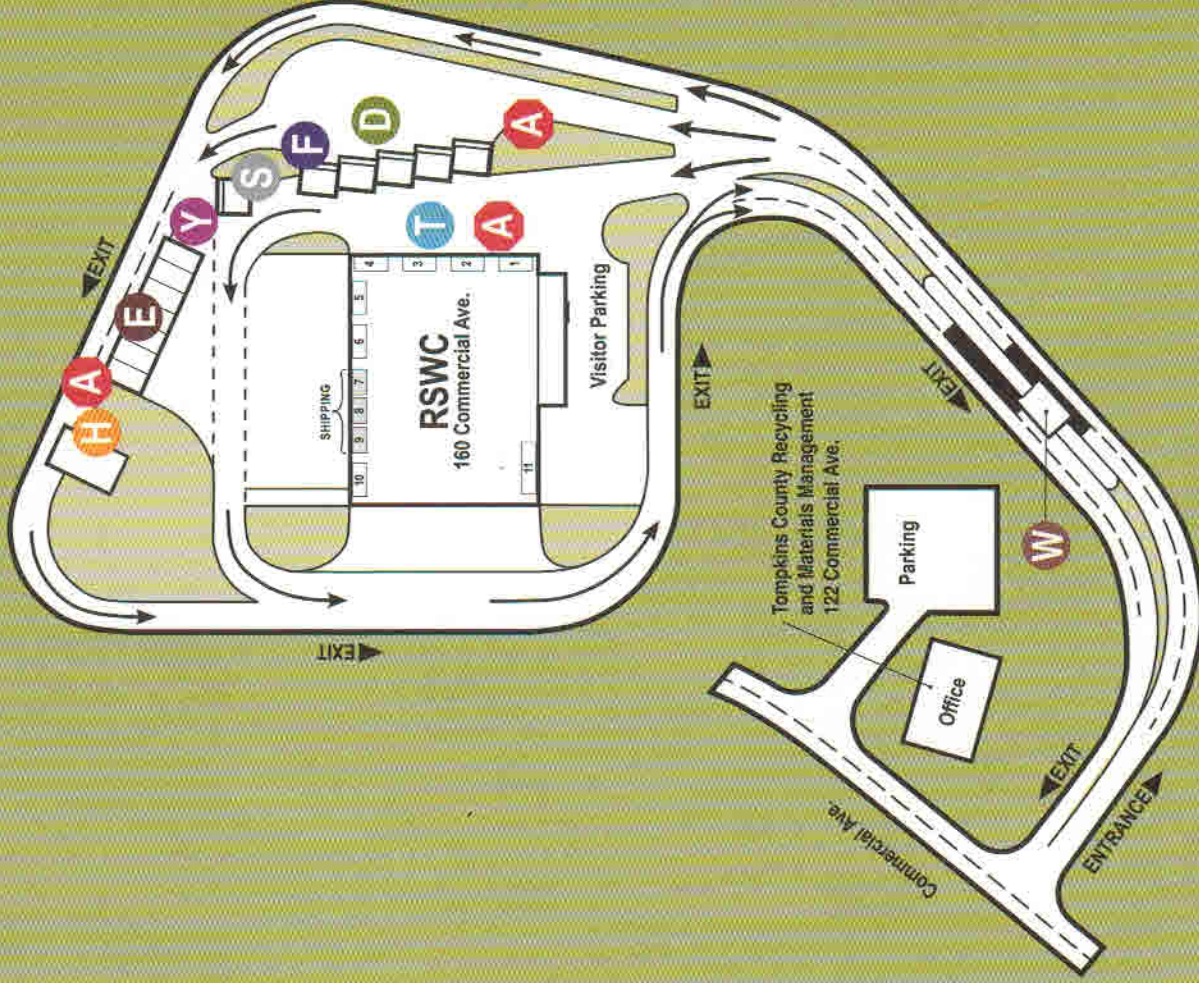

**Recycling & Materials Management Office**  
Hours: Mon. - Fri. 8am - 4:30pm

**Recycling and Solid Waste Center**  
Hours: Mon. - Sat. 7am - 3:30pm